

TOP VIEW SCALE 1:5

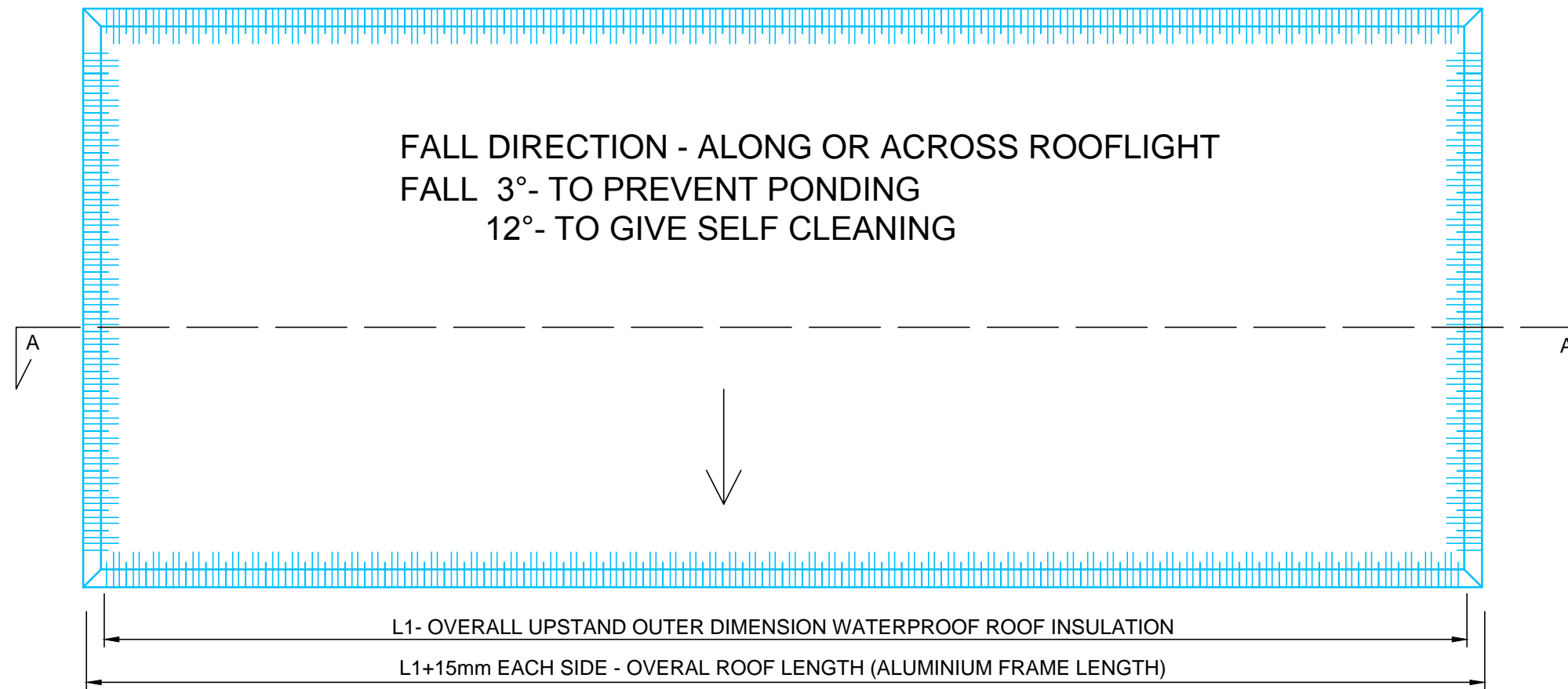

| | |
|----|--|
| 1 | DOW CORNING® 791 (LOW MODULUS) WEATHERPROOFING ELASTOMERIC SILICONE SEALANT |
| 2 | FACTORY INSTALLED EXPANDED NEOPRENE CORD |
| 3 | UNIQUE POLYESTER POWDER COATED ALUMINIUM FRAME |
| 4 | FACTORY INSTALLED MEDIUM GRADE EXPANDED NEOPRENE STRIP |
| 5 | POLYESTER POWDER COATED 12 X 1/2" STAINLESS STEEL WOODSCREWS FIXINGS LOCATED AT APPROX. 500MM CENTRES |
| 6 | WATERPROOF ROOF COVERING (FELT, ASPHALT, BITUMEN ETC.) |
| 7 | FULLY WEATHERED STRUCTURAL UPSTAND MUST PROVIDE SECURE FIXING POINT AND SUPPORT FOR ROOFLIGHT. THERE MUST BE NO STEPS OR UNDULATIONS ON THE TOP SURFACE THAT EXCEED ±2MM |
| 8 | INTERNAL FINISHES (PLASTERBOARD ETC.) |
| 9 | TOUGHENED DOUBLE OR TRIPLE GLAZED UNIT |
| 10 | WALK-ON DOUBLE SAFETY GLASS, TOUGHENED & LAMINATED 26MM/20ARGON/6MM TOUGHENED LOWE WITH WARM EDGE SPACER BAR. U-VALUE 1.2W/M²K |
| 11 | OPTIONAL KERB TOP TRIM DETAIL |

SECTION B-B SCALE 1:2

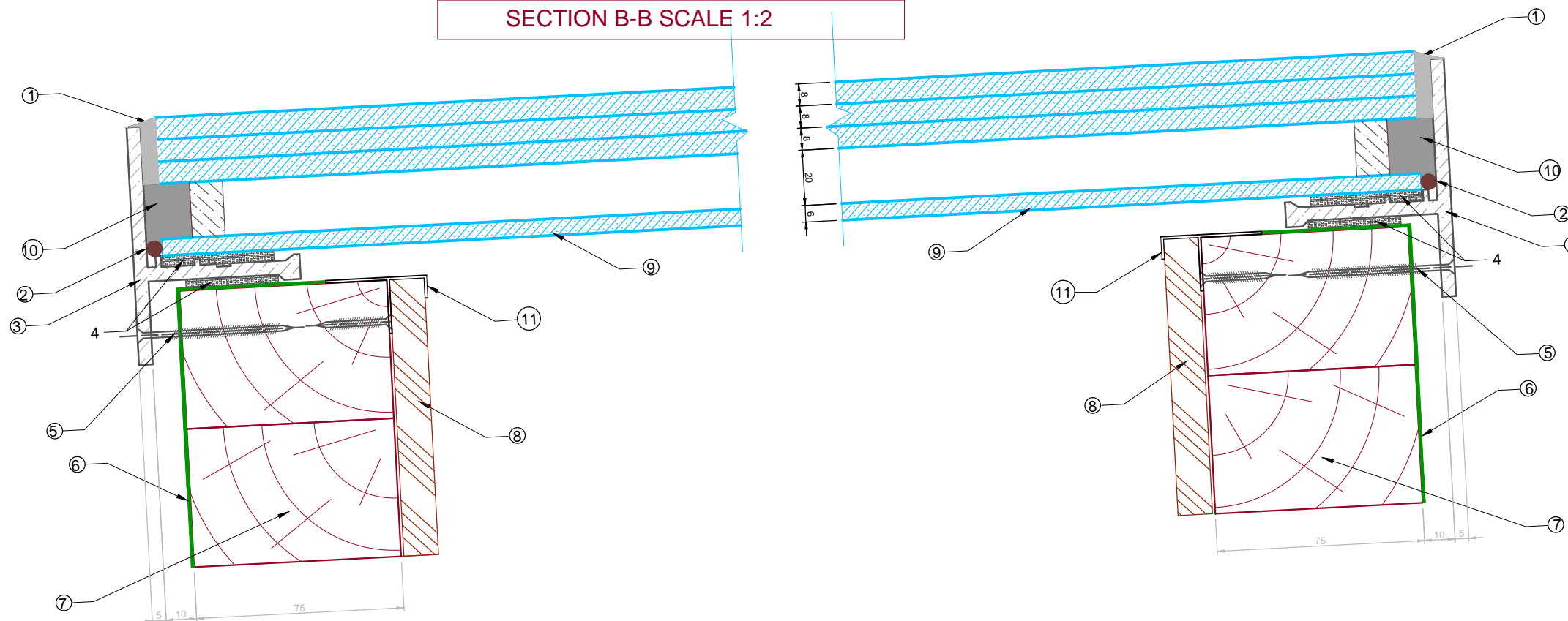

WINDOW RL-85/60 WALK ON

GLASS U-VALUE = 1.2W/m²k

GLAZING - toughened, Low-E, double or triple, argon gas filled

COLOUR - according to client's specification

DIMENSIONS - according to drawings and clients specification

MATERIAL - alloy 6060, according to EN 573-3, in Temper T66, according to EN 755-2 and with tolerances according to EN 755-9

DM Window Solutions Ltd

Lombard Business Park
8 Lombard Road
London SW19 3TZ
t: 0203 174 0208 f: 0208 541 2299
e: sales@dmwindowsolutions.co.uk
www.dmwindowsolutions.co.uk

| | |
|-------------------------------|---------|
| TITLE: | CLIENT: |
| WINDOW RL-85/60 WALK ON | |
| STATUS : CONSTRUCTION | |
| SCALE: 1:2 1:5 | 2014 |
| | A/7 |