

TOP VIEW SCALE 1:5

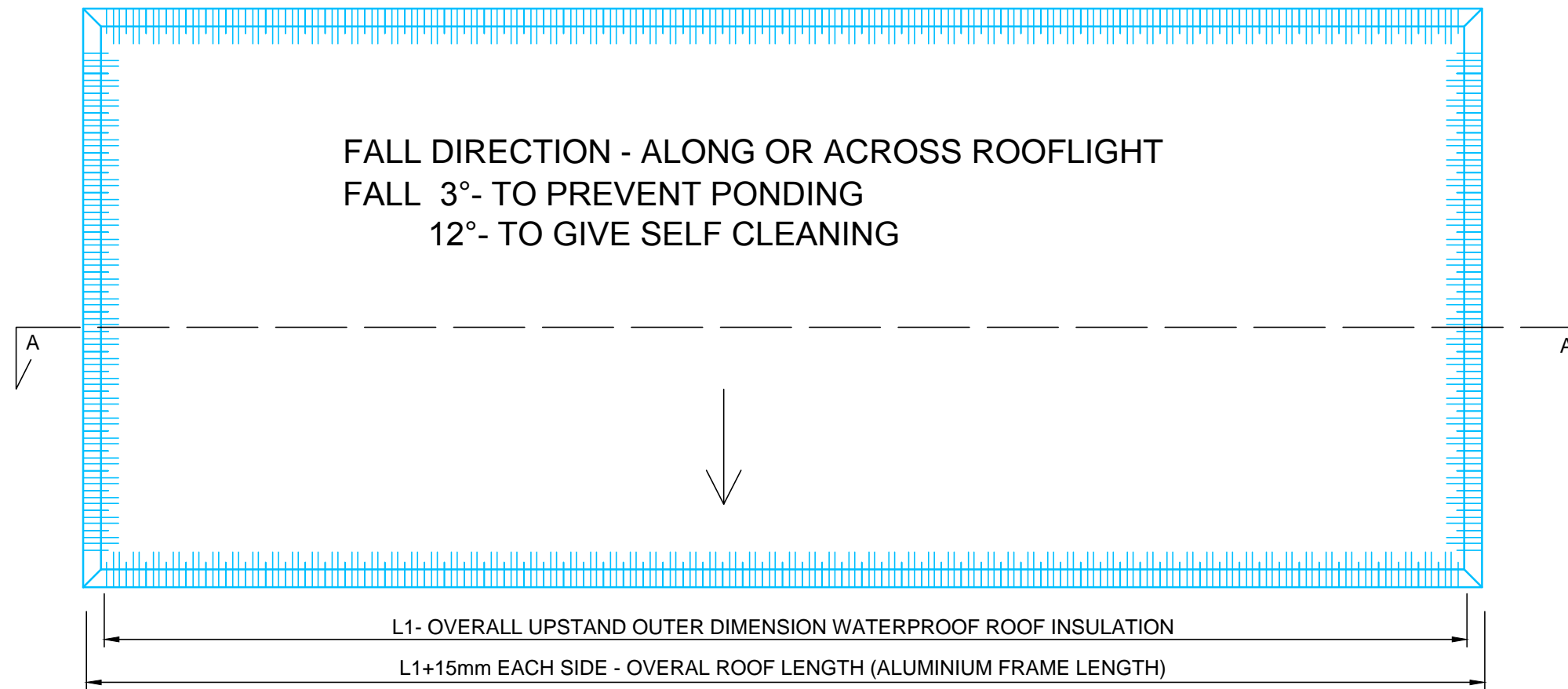

1	DOW CORNING® 791 (LOW MODULUS) WEATHERPROOFING ELASTOMERIC SILICONE SEALANT
2	FACTORY INSTALLED EXPANDED NEOPRENE CORD
3	UNIQUE POWDER COATED ALUMINIUM FRAME
4	FACTORY INSTALLED MEDIUM GRADE EXPANDED NEOPRENE STRIP
5	POWDER COATED 12 X 1/2" STAINLESS STEEL WOODSCREWS FIXINGS LOCATED AT APPROX. 500MM CENTRES
6	WATERPROOF ROOF COVERING (FELT, ASPHALT, BITUMEN, GRP ETC.)
7	FULLY WEATHERED STRUCTURAL UPSTAND
8	INTERNAL FINISHES (PLASTERBOARD ETC.)
9	DOUBLE SAFETY GLASS, TOUGHENED 8MM/18ARGON/6MM LOW E TOUGHENED WITH WARM EDGE SPACER BAR WITH U-Value 1.1W/m²K
10	SPECIAL HOT MELT SEALANT TO PREVENT UNSEALING OF GLASS UNITS.
11	OPTIONAL KERB TOP TRIM DETAIL

SECTION B-B SCALE 1:2

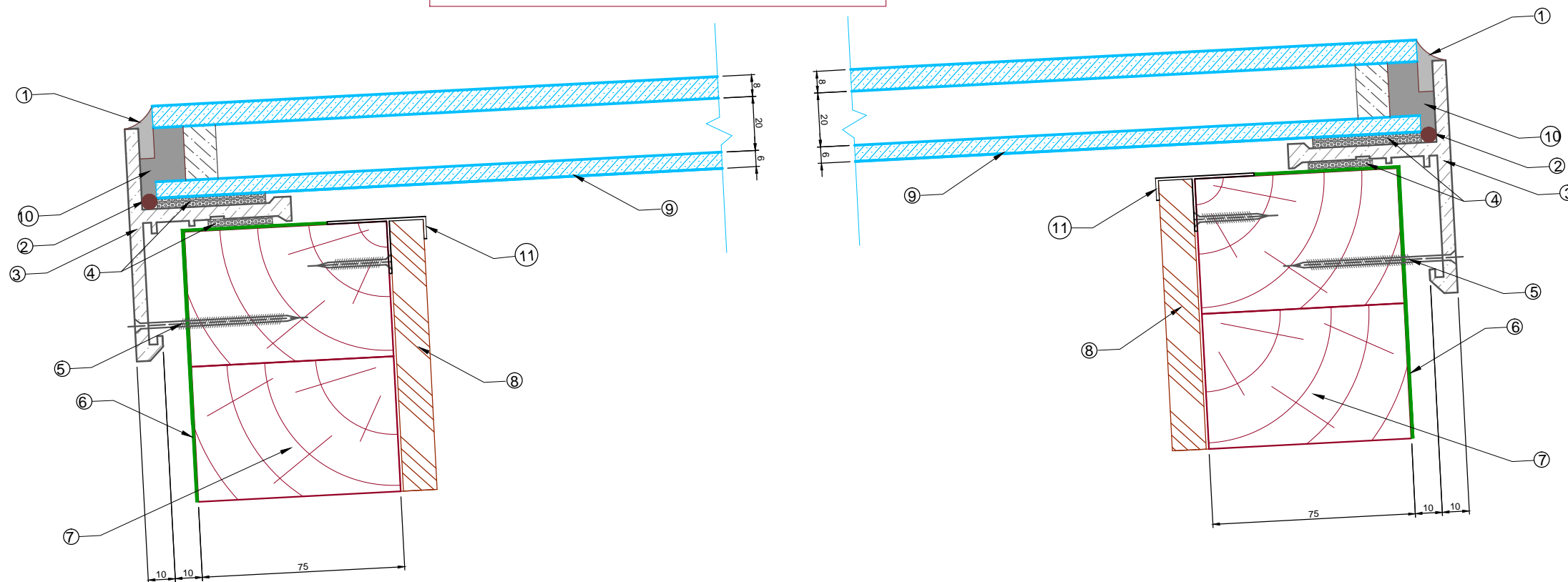

WINDOW RL-85/60

GLASS U-VALUE = 1.1W/m²k  
 GLAZING - toughened, Low-E, double or triple, argon gas filled  
 COLOUR - according to client's specification

DIMENSIONS - according to drawings and clients specification  
 MATERIAL - alloy 6060, according to EN 573-3, in Temper T66, according to EN 755-2 and with tolerances according to EN 755-9

DM Window Solutions Ltd

Lombard Business Park  
 8 Lombard Road  
 London SW19 3TZ  
 t: 0203 174 0208 f: 0208 541 2299  
 e: sales@dmwindowsolutions.co.uk  
 www.dmwindowsolutions.co.uk

TITLE:	CLIENT:
WINDOW RL-85/60	

STATUS : CONSTRUCTION		
SCALE: 1:2 1:5	2014	A/5